

A

B

C

D

E

F

A

B

C

D

E

F

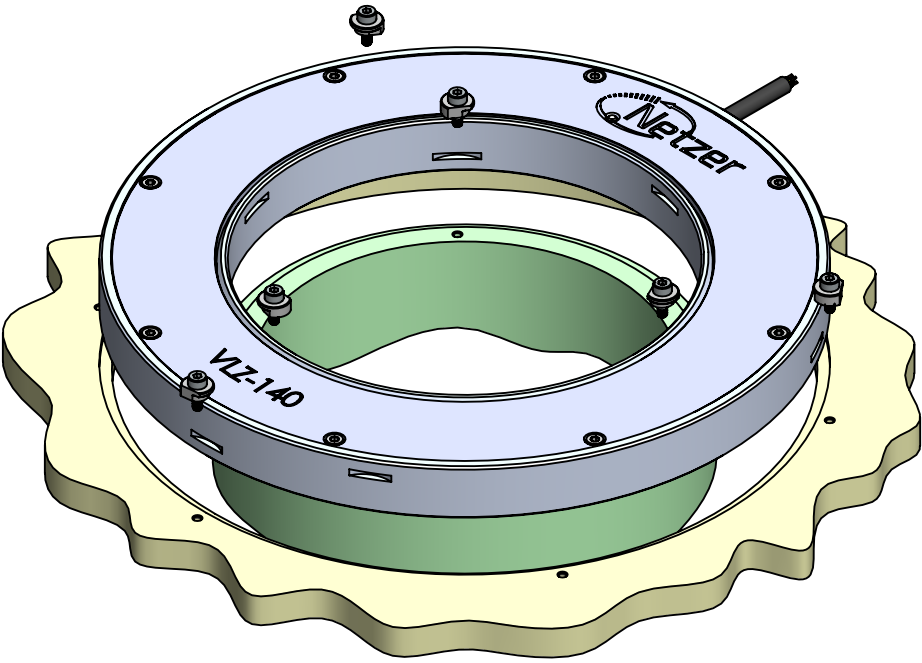
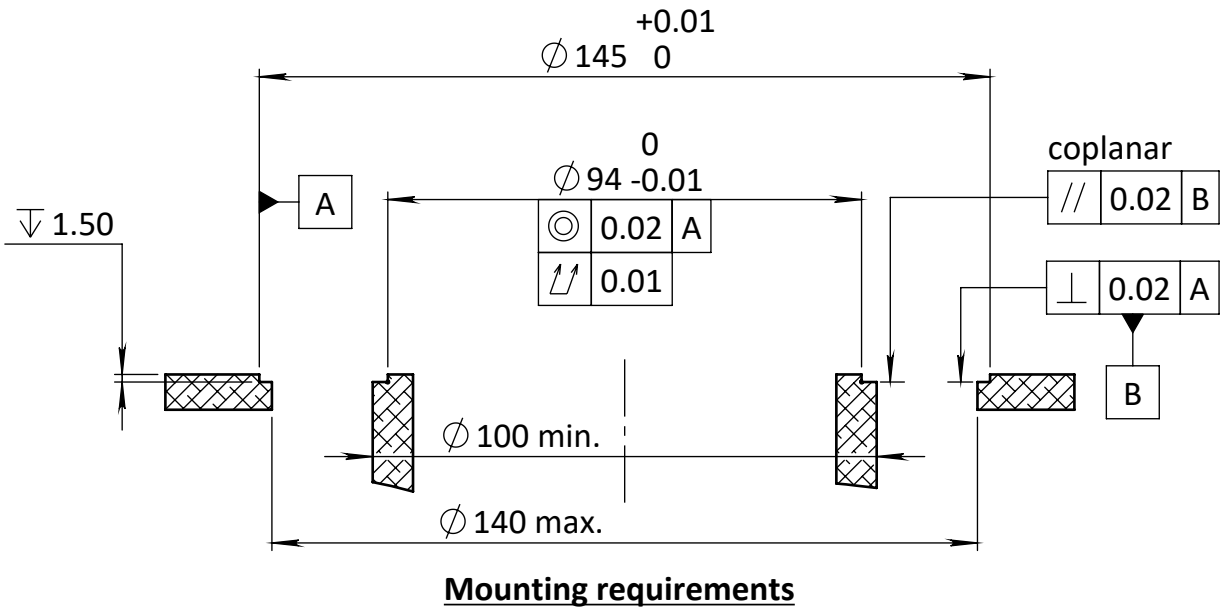
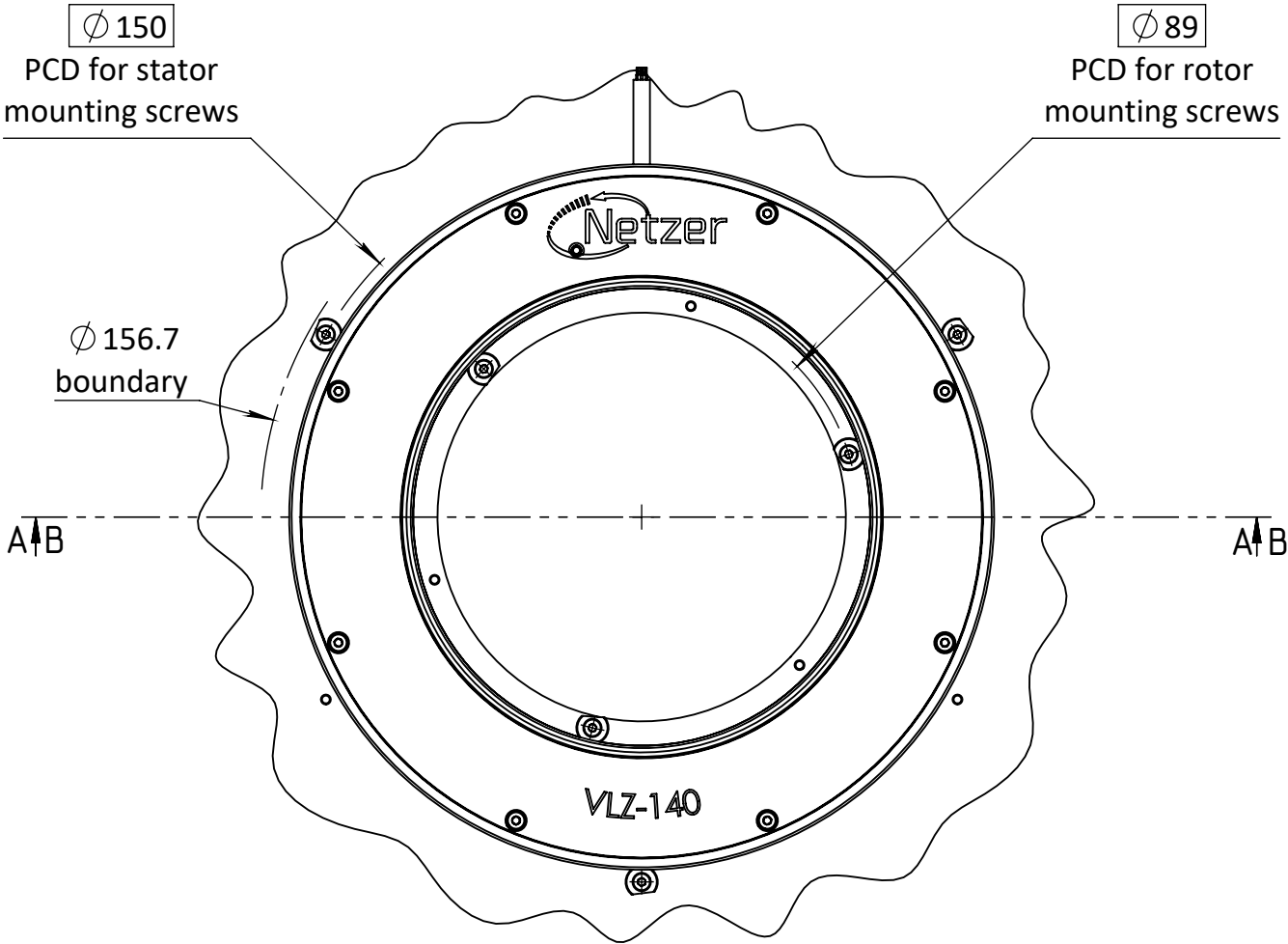
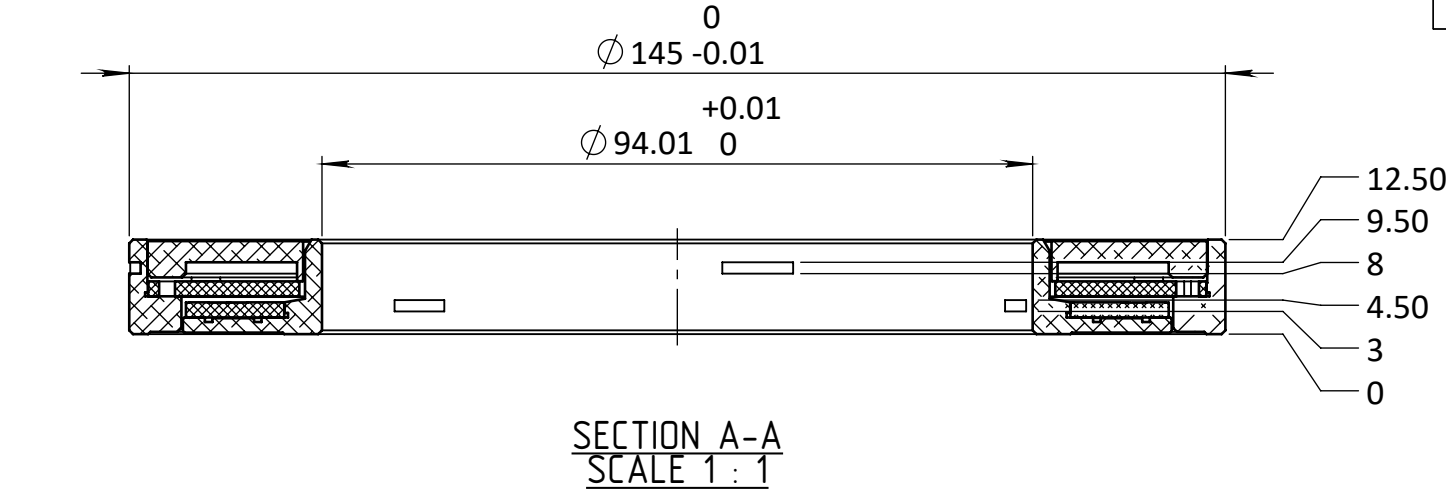

Shaft end with shoulder mounting - sample

Notes:
1. It is important to ground the shaft during use.

The information contained in this drawing is the sole property of Netzer Precision Position Sensors A.C.S. Ltd. Any reproduction in part or whole without the written permission of Netzer Precision Position Sensors A.C.S. Ltd. is prohibited. The drawing is confidential, and is the property of Netzer Precision Ltd. It must not be disclosed to a third party without written consent of Netzer Precision Ltd.			
NAME	SIGNATURE	DATE	
DRAWN Michael Agami	MA	29-Jun-2025	
CHK'D			
APPV'D			
UNLESS OTHERWISE SPECIFIED:			TITLE: VLZ-140 Mechanical interface
DIMENSIONS ARE IN: mm		SURFACE FINISH: N6	
0.5 - 4.9: ±0.05 mm		5 - 30: ±0.1 mm	
31 - 120: ±0.15 mm		121 - 400: ±0.2 mm	
401 - 1000: ±0.3 mm		1001 - 2000: ±0.5 mm	
Between holes: ±0.05 mm		Angles: ±0.5°	
On all edges make chamfer 0.1 mm x 45°			
MATERIAL:			Coating: Note 3
PROJECT: VLZ-140			Revision: 00
CAT NO.: VLZ-140 ICD			
			SCALE: 1:1.5
			A3
			SHEET 1 OF 1