

13		14		15		16	
REVISIONS							
ZONE	REV.	DESCRIPTION		DATE		DRAWN	

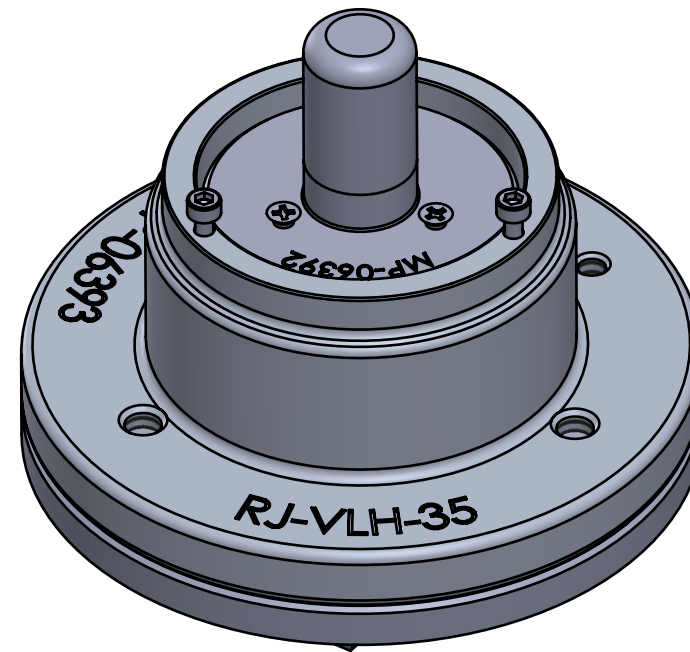
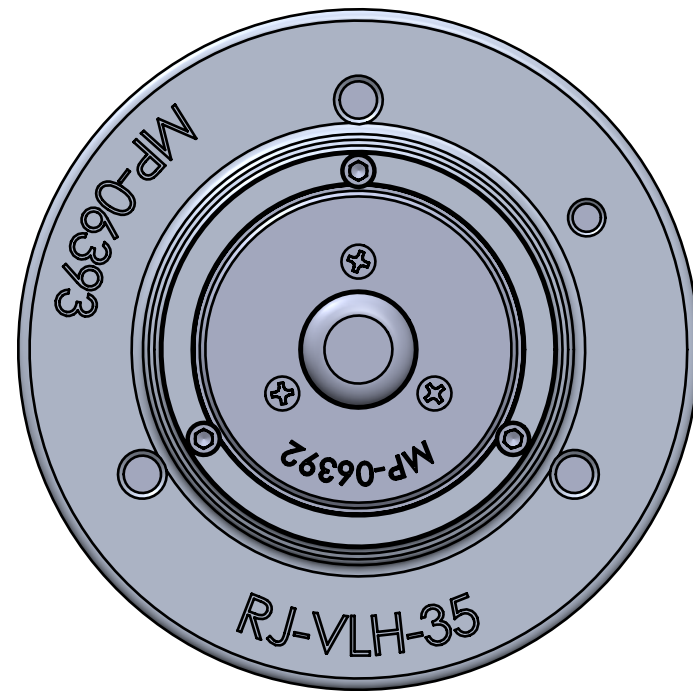
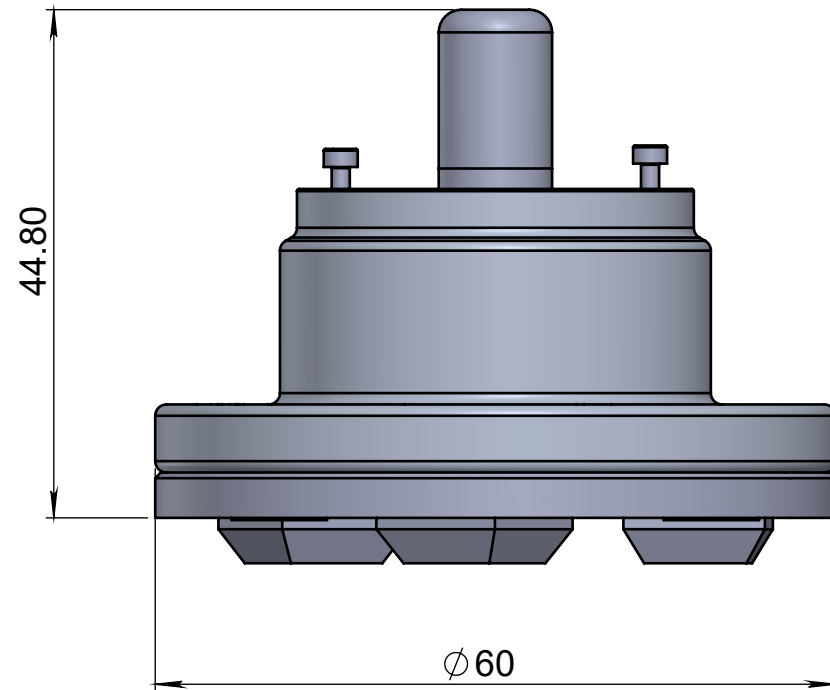

Notes:

1. For any incompatibility with the model or missing dimension, please refer to Netzer for clarification.
2. Burrs are not allowed
3. Packing must prevent physical damage during process storage and shipment

The information contained in this drawing is the sole property of Netzer Precision Position Sensors A.C.S. Ltd. Any reproduction in part or whole without the written permission of Netzer Precision Position Sensors A.C.S. Ltd. is prohibited. The drawing is confidential, and is the property of Netzer Precision Ltd. It must not be disclosed to a third party without written consent of Netzer Precision Ltd.

<div> <div> <div></div> <div>NAME</div> </div> <div> <div>SIGNATURE</div> <div>DATE</div> </div> </div>				<div>  <div> <div>Netzer</div> <div>Precision Position Sensors A.C.S. Ltd.</div> </div> </div>	
DRAWN	Gal Horner	GH	30.01.2022	<div> <div>TITLE:</div> <div>VL-35-H HOLLOW SHAFT ROTATING JIG (RJ)</div> <div>  </div> </div>	
CHK'D					
APP'V'D	Sharon Hadad	SH	30.01.2022		
<div> <div>UNLESS OTHERWISE SPECIFIED:</div> <div> <div>DIMENSIONS ARE IN: mm</div> <div>SURFACE FINISH: N6</div> </div> </div>				<div> <div>Coating:</div> <div>SCALE: 1.5:1</div> </div>	
<div> <div>0.5 - 4.9: ±0.05 mm</div> <div>5 - 30: ±0.1 mm</div> </div>				<div> <div>MATERIAL: ALUMINUM</div> <div>Revision : 01</div> </div>	
<div> <div>31 - 120: ±0.15 mm</div> <div>121 - 400: ±0.2 mm</div> </div>				<div> <div>PROJECT : VL-35-H</div> <div>CAT NO. : 22.07.2025 RJ-VL-35-H</div> </div>	
<div> <div>401 - 1000: ±0.3 mm</div> <div>1001 - 2000: ±0.5 mm</div> </div>				<div> <div>A3</div> <div>SHEET 2 OF 2</div> </div>	
<div> <div>Between holes: ±0.05 mm</div> <div>Angles: ±0.5°</div> </div>				<div> <div>On all edges make chamfer 0.1 mm x 45°</div> </div>	