

REVISIONS			
REV.	DESCRIPTION	DATE	BY
03	Whole ultem rotor, mounting requirement changed	06-Oct-2020	Michael A.
04	ICD remake	29-May-2025	Michael A.

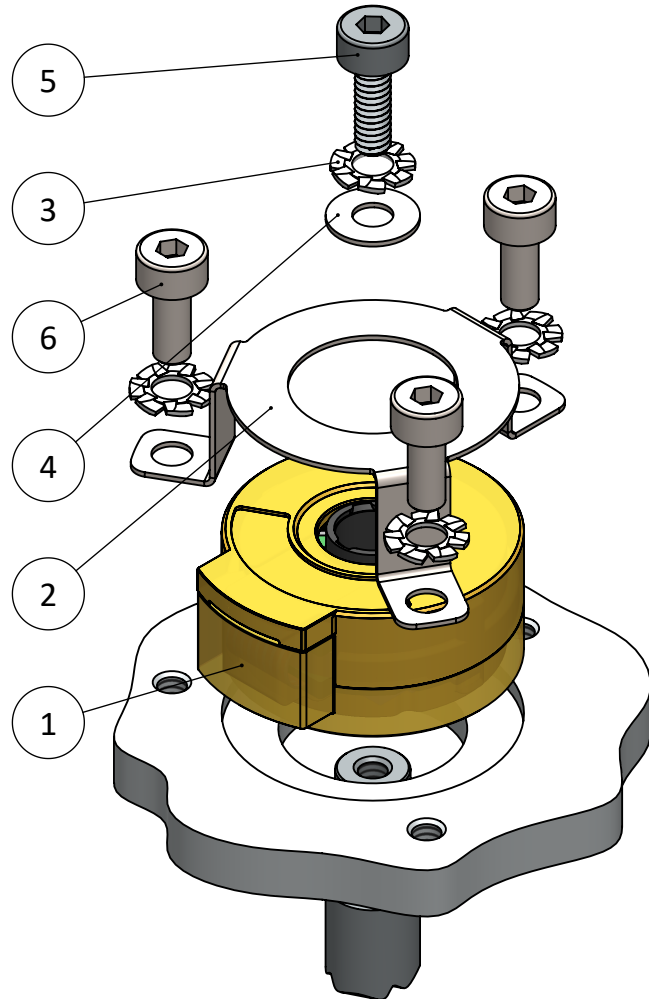

Nº	PART NUMBER	DESCRIPTION	QTY.	INCLUDED	TORQUE
1	DS-16 Assembly		1	✓	—
2	MP-03649	DS-16 Mounting bracket	1	✓	—
3	MP-03491	DIN 6798A Star washer, M2	4	✓	—
4	MP-01102	Flat washer, DIN 125, M2 - ID 2.2	1	✓	—
5	PP00247	Hex socket screw, DIN 912, M2x6	1	✓	0.1 Nm
6	MP-01209	Hex socket screw, DIN 912, M2x5	3	✓	0.1 Nm

The information contained in this drawing is the sole property of Netzer Precision Motion Sensors Ltd. Any reproduction in part or whole without the written permission of Netzer Precision Motion Sensors Ltd. is prohibited. The drawing is confidential, and is the property of Netzer Precision Ltd. It must not be disclosed to a third party without written consent of Netzer Precision Ltd.

NAME	SIGNATURE	DATE
DRAWN	Michael Agami	MA
CHK'D		2018-02-27
APPV'D		

UNLESS OTHERWISE SPECIFIED:
DIMENSIONS ARE IN: mm
SURFACE FINISH: N6
LINEAR TOLERANCES: ±0.1 mm
ANGULAR TOLERANCES: ±0.5 deg
ALL CHAMFER: 0.1 mm x 45°

Netzer Precision Position Sensors A.C.S. Ltd.

TITLE: *DS-16 Mechanical interface*

MATERIAL: _____ Coating: _____

PROJECT: *DS-16* Revision: *04*

CAT NO.: *DS-16 ICD*

SCALE: 2.5:1

A3

SHEET 1 OF 1

WARNING
Do not use Loctite or any other glue containing Cyanoacrilate. Netzer recommends to use 3M™ Scotch-Weld™ Epoxy Adhesive EC-2216 B/A.